

Per 50/100 (PC 50)

Peripheral
pump

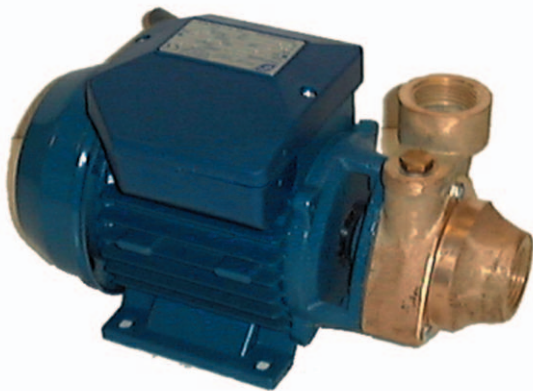

Applications

Domestic water supply, pressurisation,

Materials

Pump Body
Bronze.

Impeller
Brass.

Motor Shaft
Stainless steel. AISI 416.

Mechanical Seal
Graphite and ceramic.

Motor

Class F insulation.
IP 44 Protection.
Continuous operation.
Single phase with built-in thermal protection.

Limitations

Maximum temperature of liquid: 60°C.

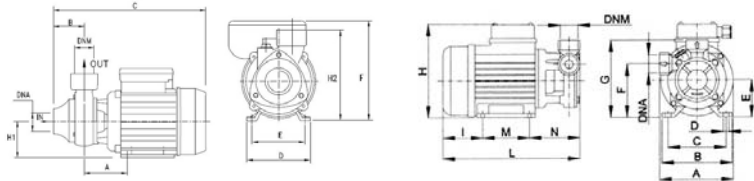
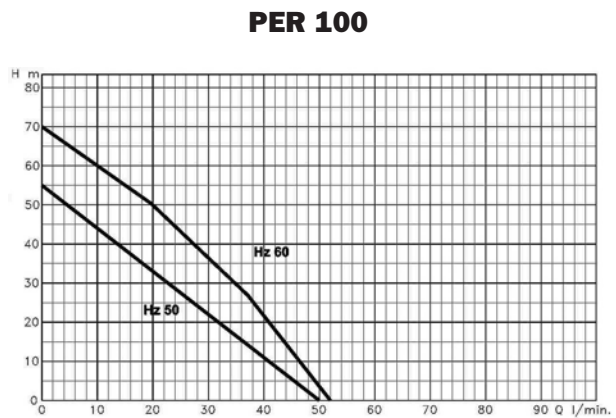
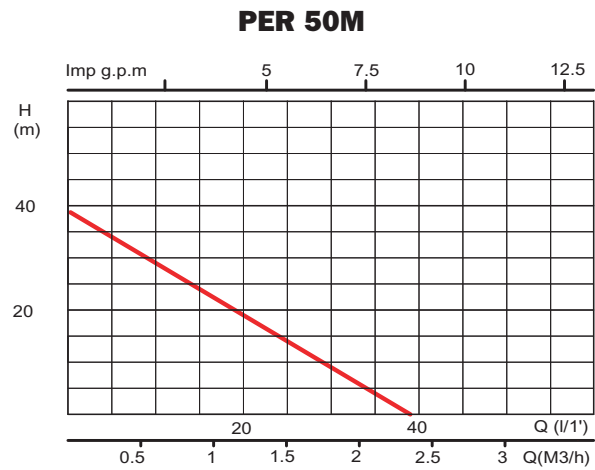

Per 50

Per 100

	A	B	C	D	E	F	G	H	I	L	M	N	Dna	DNm	kg
Per 50M	67	20	265	125	100	155	63	143	265	145	165		1"	1"	5.7
Per 100M	155	135	112	12	68	107	148	169	75	273	90	108	1"	1"	9.5

Single phase	Price	l/1'	5	10	20	30	40	A			P1 (kW)		kW	HP	µF
								1~	3~	230 V	230 V	400 V			
Per 50 M (PC 50)	160	m³/h	0.3	0.6	1.2	1.8	2.9	2.1				0.49	0.37	0.5	12
Per 100M (per 80)	205	H [m]	50	44	32	21	10	3.8				1.8	1.0	1.5	18