

# Hydromassage pumps

# Wiper 3

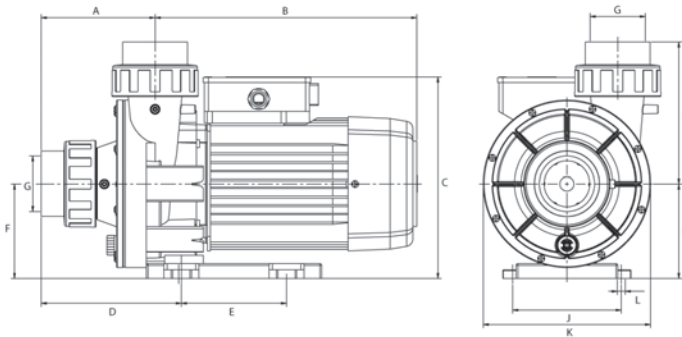
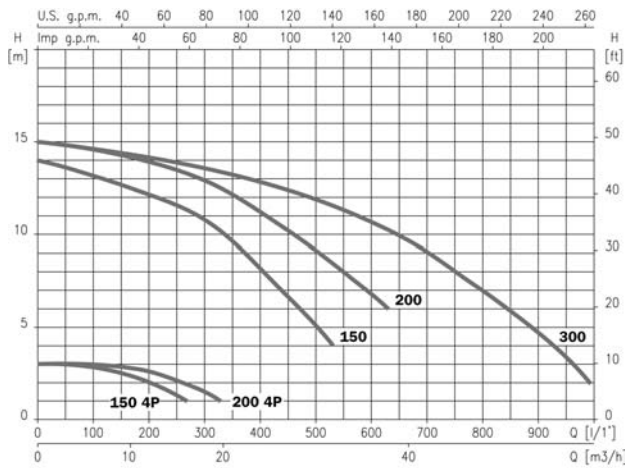

	A	B	C	D	E	F	G	H	I	J	K	L	M	Kg
Wiper3 150M	130	298.7	230	160	120	108	63	162	108	124	191	9	29	14.3
Wiper3 150M	130	298.7	230	160	120	108	63	162	108	124	191	9	29	17
Wiper3 200M	130	298.7	230	160	120	108	63	162	108	124	191	9	29	17
Wiper3 300M	130	298.7	230	160	120	108	63	162	108	124	191	9	29	18.8

230 V 50 hz	230/400 V 50 hz	Price	A			P1 (kW)		kW	HP	µF	l/1'									
			1~ 230 V	3~		1~	3~				m³/h									
				230 V	230 V						400 V	50	100	200	300	400	500	600	900	
Wiper3 150M	2P	Wiper3 150	<b>391</b>	6.4	5	2.9	1.4	1.2	1.1	1.5	25	13.3	13	12.1	10.8	8.2	5			
	4P		<b>463</b>	1.4	-	-	0.35	-	0.18	0.25	16	3	2.8	2						
Wiper3 200M	2P	Wiper3 200	<b>451</b>	8.8	6.6	3.8	2	1.8	1.5	2	40	14.8	14.5	13.9	12.9	11.1	9.1	6.8		
	4P		<b>523</b>	1.7	-	-	0.4	-	0.18	0.25	16	3	2.8	2.6	1.5					
Wiper3 300M		Wiper3 300	<b>583</b>	11	7.1	4.1	2.5	2.4	2	3	60	14.8	14.5	14.1	13.5	12.8	11.9	10.7	4.7	

See our whirlpool accessories catalogue for full details

## Applications

For use with domestic and commercial spa's.

## Materials

### Pump Body

Glass loaded polypropylene

### Impeller

Glass loaded noryl.

### Shaft

Stainless steel AISI 420.

### Mechanical Seal

Graphite and alumine.

## Motor

Insulation resistance 3750 V.

Class F Insulation.

Protection IP 55.

Continuous operation.

Built-in thermal protection.

## Equipment

Complete with suction and discharge connections metric or imperial.